

Submitted Model No.: \_\_\_\_\_

Specific Features: \_\_\_\_\_

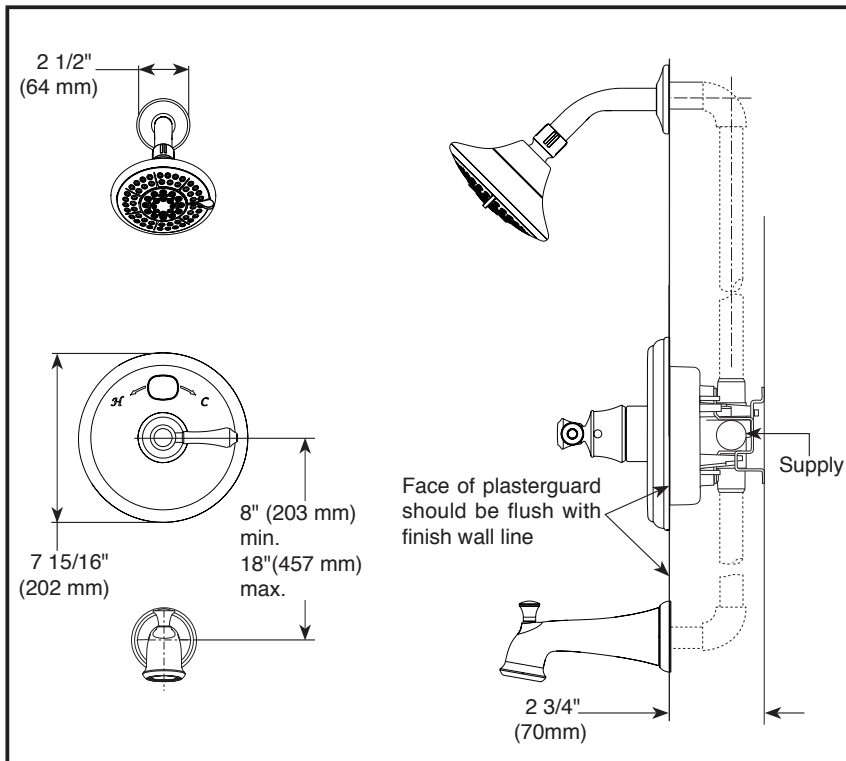

#### RP78575 ▲ (Showerhead)

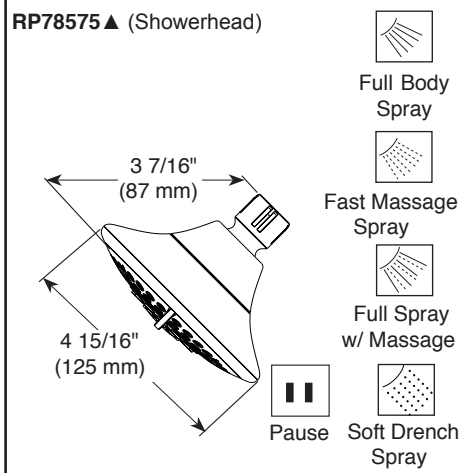

#### RP52153 ▲ (Pull-Up Diverter)

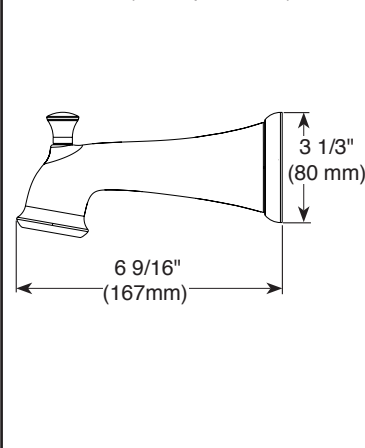

#### ▲ Designate proper finish suffix

Delta reserves the right (1) to make changes in specifications and materials, and (2) to change or discontinue models, both without notice or obligation. Dimensions are for reference only. See current full-line price book or [www.deltafaucet.com](http://www.deltafaucet.com) for finish options and product availability.

DSP-B-144984-T2O Rev. B



## TUB AND SHOWER FAUCET

### ■ Tub and Shower

#### FEATURES:

- Monitor® 14 Series pressure balance bath mixing valve with Scald-Guard®
- TempO™ Tub/Shower
- Touch-Clean® nozzles

#### STANDARD SPECIFICATIONS:

- Maintains a balanced pressure of hot and cold water even when a valve is turned on or off elsewhere in the system
- For use with MultiChoice® Universal rough valve body. (R10000 Series)
- Back-to-back installation capability
- Solid brass forged body
- Temperature only controlled with handle
- Field adjustable to limit handle rotation into hot water zone
- 120° maximum handle rotation
- Temperature display changes color as temperature increases
- Easy-turn 5-spray adjustable showerhead
- Uses 3 AAA batteries (included)
- Low battery indicator on LED screen

#### WARRANTY

- Lifetime limited warranty on parts (other than electronic parts and batteries) and finishes; or, for commercial users, for 5 years from the date of purchase.
- 5 year limited warranty on electronic parts (other than batteries); or for commercial users, for 1 year from the date of purchase. No warranty is provided on batteries.



#### COMPLIES WITH

- ASME A112.18.1 / CSA B125.1
- Indicates compliance to ICC/ANSI A117.1 - Valve control only
- EPA WaterSense®

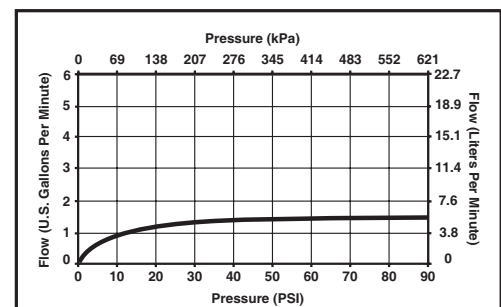

55 E. 111th Street, Indianapolis, Indiana 46280  
350 South Edgeware Road, St. Thomas, Ontario Canada N5P 4L1  
© 2015 Masco Corporation of Indiana